



Part No. ALL50104  
ALL50105

## Bolt-In Adapter Fittings

Bulkhead style aluminum fittings adapt 3/16" inverted flare line to an AN type fitting. The 9/16" threaded body with attaching nut can be mounted through a C-channel style frame or a chassis tab.

Part No:	Description
ALL50104.....	3/16" To -3AN
ALL50105.....	3/16" To -4AN

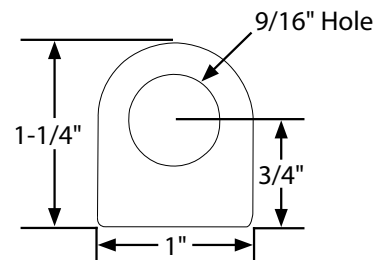

### Related Parts:

- ALL60092.....Mounting Tabs Weld-On With 9/16" Hole, 4-Pack
- ALL99294.....Replacement Nut For ALL50104/50105

REV032417

**Allstar Performance 8300 Lane Dr., Watervliet, MI 49098**  
**Phone: (269) 463-8000 Fax: (800) 772-2618 [www.allstarperformance.com](http://www.allstarperformance.com)**